

DIRECT THERMAL PRINTER
ACS



FEATURES

- Direct thermal monochrome print method
- ZPL and EPL programming languages
- 5 status icon, 3 button user interface
- USB 2.0, USB Host
- OpenACCESS™ for easy media loading
- Dual-wall frame construction
- ENERGY STAR qualified
- Including label dispenser, 1 roll of 2 x 57 mm labels, cables and fully configured
- Bluetooth low energy
- Compatible with Henkelman Advanced Control System

PRINTER SPECIFICATIONS

- Resolution 203 dpi/8 dots per mm
- Memory: 512 MB Flash; 256 MB SDRAM
- Maximum print width: 56 mm for 203 dpi
- Maximum print speed: 152 mm per second (203 dpi)
- Firmware: ZPL II, EPL 2, EPL Line Mode, XML, ZBI

DESCRIPTION

This ultra-compact printer creates high-quality labels. Compatible with Henkelman's Advanced Control System. Easy to use and operate, especially fit for food service purposes.



Henkelman offers standard 3 year warranty

DIRECT THERMAL PRINTER (ACS) – SPECS

DIRECT THERMAL PRINTER (ACS) – SPEC SHEET

DIMENSIONS

In mm

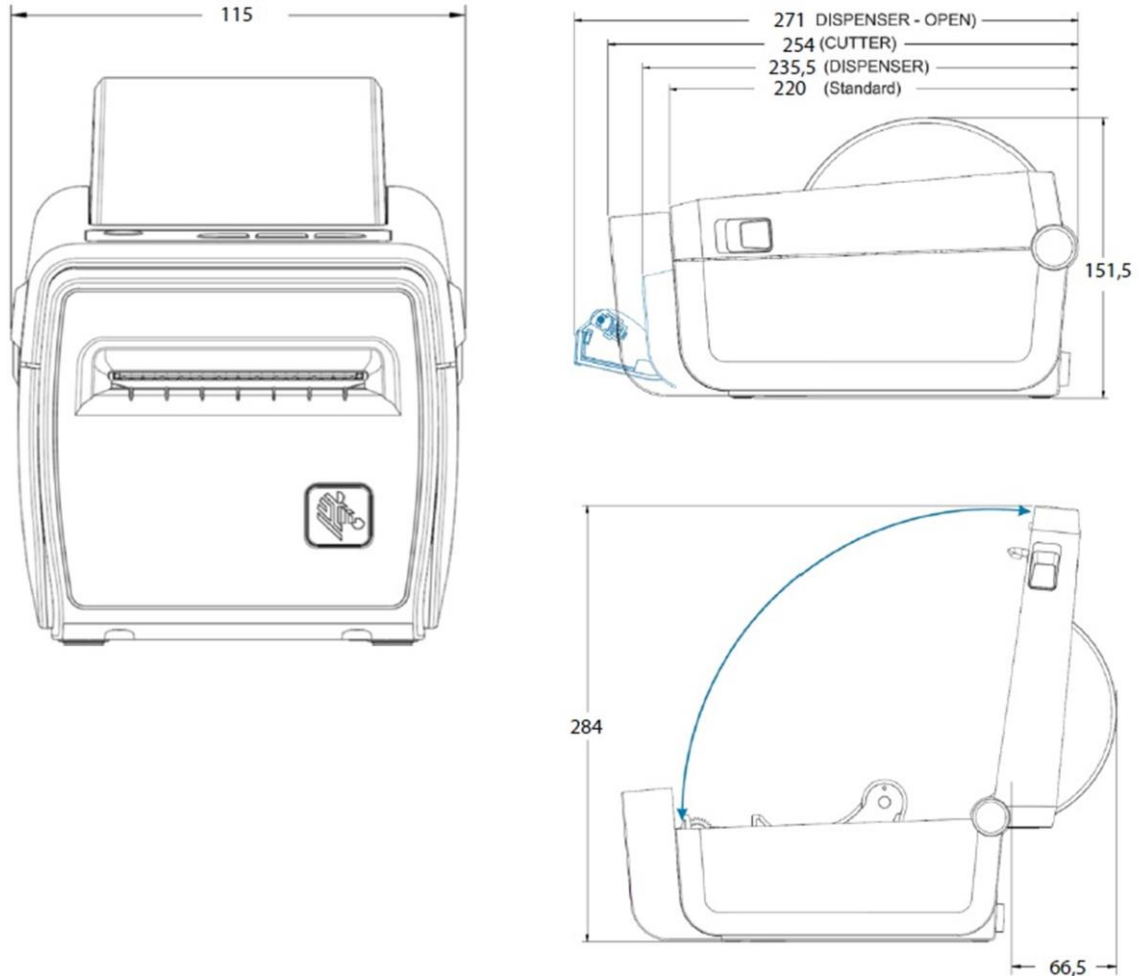

Model	Dimensions (mm)	Hz	Electrical	Weight (kg)
Zebra ZD410	L x W x H 220 x 115 x 151	50-60 Hz	Auto-detectable (PFC Compliant) 90-265VAC ENERGY STAR qualified	1



HENKELMAN BV
Titaniumlaan 10
5221 CK 's-Hertogenbosch
The Netherlands

Sales support
P +31 73 621 36 71
E info@henkelman.com
Service/technical support
P +31 73 621 36 71
E service@henkelman.com